

GENERAL NOTES

- ALL WORK SHALL BE IN ACCORDANCE WITH THE LATEST PRINCE GEORGE'S COUNTY STANDARDS AND SPECIFICATIONS MANUAL, THE LATEST PRINCE GEORGE'S COUNTY DETAIL MANUAL AND IN ACCORDANCE WITH CURRENT COUNTY ORDINANCES.
- CONTRACTOR IS RESPONSIBLE FOR CONTACTING "MISS UTILITY" AT 1-800-257-7777, 48 HOURS PRIOR TO ANY EXCAVATION WORK.
- THE DEVELOPER IS RESPONSIBLE TO HOLD A "PRECONSTRUCTION" MEETING TO INCLUDE THE CONTRACTOR, PRINCE GEORGE'S COUNTY INSPECTION PERSONNEL, PUBLIC UTILITIES, AND ANY LOCAL, STATE OR FEDERAL AGENCIES AS REQUIRED PRIOR TO THE START OF CONSTRUCTION.
- THE CONTRACTOR IS RESPONSIBLE FOR CONTACTING THE PRINCE GEORGE'S COUNTY DEPARTMENT OF PERMITTING, INSPECTION AND PERMITTING (DPIE) 5 DAYS PRIOR TO THE START OF ALL CONSTRUCTION IN ACCORDANCE TO ALL PERMITS ISSUED.
- MAXIMUM SLOPES SHALL BE NOT GREATER THAN THREE (3) FEET HORIZONTAL TO ONE (1) FOOT VERTICAL OUT SIDE THE ROAD RIGHT-OF-WAY. SLOPES WITHIN THE ROAD RIGHT-OF-WAY SHALL BE NOT GREATER THAN TWO (2) FEET HORIZONTAL TO ONE (1) FOOT VERTICAL, OR UNLESS SPECIFIED ON THE PLANS.
- CERTIFIED COMPACTION TESTS ARE REQUIRED FOR ALL TRENCH/FILL WORK IN ACCORDANCE WITH THE LATEST EDITION OF THE SPECIFICATIONS MANUAL AND GRADING ORDINANCE. FINAL REPORTS AND CERTIFICATIONS SHALL BE PROVIDED PRIOR TO PRE-FINAL INSPECTIONS.
- CERTIFIED COMPACTION TESTS AND GEOTECHNICAL REPORTS SHALL BE SUBMITTED ON A REGULAR BASIS THROUGHOUT THE COURSE OF CONSTRUCTION AS REQUIRED BY THE SPECIFICATIONS MANUAL.
- AS-BUILT PLANS SHALL BE SUBMITTED PRIOR TO PRE-FINAL INSPECTIONS FOR ALL DISCIPLINES.
- WITH APPROVAL FROM THE PRINCE GEORGE'S COUNTY SEDIMENT CONTROL INSPECTOR, ALL EROSION AND SEDIMENT CONTROL STRUCTURES MUST BE REMOVED PRIOR TO THE RELEASE OF BONDS.
- THERE ARE NO KNOWN HISTORIC SITES LOCATED WITHIN THIS SITE.
- OBSTRUCTIONS SHOWN ON THIS DRAWING ARE FOR THE CONVENIENCE OF THE CONTRACTOR ONLY. THE CONTRACTOR MUST VERIFY ALL SUCH INFORMATION TO HIS OWN SATISFACTION. IN THE EVENT THAT INFORMATION IS IN CONFLICT WITH INFORMATION OUTLINED, THE CONTRACTOR SHALL IMMEDIATELY NOTIFY THE ARCHITECT PRIOR TO STARTING ANY WORK.
- ADJUST TOP OF CURB GRADES TO SMOOTH TRANSITION.
- STRIP AND RESURFACE EXISTING PAVING AS NEEDED TO PROVIDE SMOOTH TRANSITION TO EXISTING SURFACE.
- IT SHALL BE DISTINCTLY UNDERSTOOD THAT FAILURE TO MENTION SPECIFICALLY ANY WORK WHICH WOULD NORMALLY BE REQUIRED TO COMPLETE THIS PROJECT SHALL NOT RELIEVE THE CONTRACTOR OF HIS RESPONSIBILITY TO COMPLETE SUCH WORK.
- IT SHALL BE THE RESPONSIBILITY OF THE CONTRACTOR TO NOTIFY THE ENGINEER OF ANY DEVIATION FROM THIS PLAN PRIOR TO ANY CHANGE BEING MADE, ANY DEVIATION FROM THIS PLAN WITHOUT WRITTEN AUTHORIZATION FROM THE ENGINEER WILL BE THE RESPONSIBILITY OF THE CONTRACTOR.
- SHOULD THE CONTRACTOR DISCOVER DISCREPANCIES BETWEEN THE PLANS AND FIELD CONDITIONS, THE ENGINEER IS TO BE NOTIFIED IMMEDIATELY TO RESOLVE THE SITUATION. SHOULD THE CONTRACTOR MAKE FIELD CORRECTIONS OR ADJUSTMENTS WITHOUT NOTIFYING THE ENGINEER, THEN THE CONTRACTOR ASSUMES ALL RESPONSIBILITY FOR THOSE CHANGES.
- THE CONTRACTOR SHALL NOTE THAT IN CASE OF ANY DISCREPANCY BETWEEN THE SCALED AND FIGURED DIMENSIONS SHOWN ON THESE PLANS THE FIGURED DIMENSIONS SHALL GOVERN.
- PRIOR TO BEGINNING CONSTRUCTION, THE CONTRACTOR SHALL VERIFY ALL TIE-IN ELEVATIONS.
- FILL IN STRUCTURAL AND PAVEMENT AREAS SHALL BE PLACED IN HORIZONTAL, EIGHT-INCH MAXIMUM LOOSE LIFTS AND COMPACTED TO AT LEAST 95 PERCENT OF THE MODIFIED PROCTOR MAXIMUM DRY DENSITY PER ASTM D-1557. IN AREAS TO SUPPORT FLOOR SLABS AND PAVEMENTS THE UPPERMOST ONE FOOT (AFTER COMPACTION) SHALL BE COMPACTED TO 98 PERCENT OF THE MAXIMUM DRY DENSITY. THE MOISTURE CONTENT OF THE FILL SHALL BE PROPERLY CONTROLLED DURING PLACEMENT. IN BUILDING AREAS FILL SHALL EXTEND A MINIMUM OF 10 FEET BEYOND THE BUILDING LIMITS AND FILL SLOPES NO STEEPER THAN 2:1 SHALL BE USED. SEE THE PROJECT SPECIFICATIONS FOR ADDITIONAL INFORMATION.
- ALL CONSTRUCTION SHALL BE COMPLETED IN ACCORDANCE WITH THE LATEST PRINCE GEORGE'S COUNTY STANDARD DETAILS AND SPECIFICATIONS.
- CONTRACTOR WILL ADJUST ALL FRAMES, GRATES AND COVERS OF ALL EXISTING UTILITIES WITHIN THE LIMITS OF THE CONTRACT TO THE PROPOSED GRADES, AS REQUIRED.
- CONTRACTOR WILL MAINTAIN POSITIVE DRAINAGE TO SWALES AND/OR STORM DRAIN SYSTEMS AT ALL TIMES.
- ALL EXCESS SOILS ARE TO BE DISPOSED OF ON SITE, DURING FUTURE PHASES OF THE PROPERTY, AND OR STOCKPILED IN THE LOCATION OF THE BUILDING BEING DEMOLISHED ON THE PROPERTY.

"THE MARYLAND - NATIONAL CAPITOL PARK AND PLANNING COMMISSION"  
 "DEPARTMENT OF PARKS AND RECREATION"  
 "PRINCE GEORGE'S COUNTY"

# HENSON CREEK BRIDGE REPAIR

1641 TUCKER ROAD  
 FORT WASHINGTON, MARYLAND 20744  
 PRINCE GEORGE'S COUNTY

OWNER/APPLICANT:  
 M-NCPPC  
 7833 WALKER DRIVE, 3RD FLOOR  
 GREENBELT, MD 20770  
 PHONE: (301) 454-1469  
 CONTACT: COLLEEN REGOTTI

ENGINEER:  
 KCI TECHNOLOGIES, INC.  
 11830 WEST MARKET PLACE, SUITE F  
 FULTON, MARYLAND 20759  
 PHONE: (410) 792-8086  
 CONTACT: STEPHEN JERRICK, P.E.

SITE DATA:  
 ADDRESS: 1641 TUCKER ROAD  
 FORT WASHINGTON, MARYLAND 20744  
 TAX IDENTIFICATION NO.: 1286442  
 TAX MAP/GRID: 0018/00C1  
 PARCEL: 0000  
 LIBER/FOLIO: 02512/421  
 WSSC: 200FT. SHEET: 210SE02  
 ELECTION DISTRICT: 12  
 WATER DESIGNATION: W-5  
 SEWER DESIGNATION: S-5  
 SITE AREA: 55.21 ACRES  
 ZONING: R-O-S  
 LIMIT OF DISTURBANCE: 0.81 ACRES  
 EX. IMPERVIOUS: 0.06 ACRES  
 PROP. IMPERVIOUS: 0.03 ACRES

SHEET INDEX	
SHEET NUMBER	SHEET DESCRIPTION
C-0.00	TITLE SHEET
C-1.00	FINE GRADING PLAN
C-1.01	SITE DETAILS
C-1.02	BORING LOG PLAN

### GRADING & DRAINAGE CERTIFICATION

I HEREBY CERTIFY THAT THIS PLAN CONFORMS TO THE REQUIREMENTS OF SUBTITLE 32, DIVISION 2 OF THE CODE OF PRINCE GEORGE'S COUNTY WATER RESOURCES PROTECTION AND GRADING CODES AND THAT I OR MY STAFF HAVE INSPECTED THIS SITE AND THAT DRAINAGE FLOWS FROM UPHILL PROPERTIES ONTO THIS SITE, AND FROM THIS SITE ONTO DOWNHILL PROPERTIES, HAVE BEEN ADDRESSED IN SUBSTANTIAL ACCORDANCE WITH APPLICABLE CODES.

*Stephen Jerrick* 8/4/21  
 DATE  
 STEPHEN JERRICK, P.E.  
 MD REGISTRATION NO. 35792

KCI TECHNOLOGIES, INC.  
 11830 WEST MARKET PLACE, SUITE F  
 FULTON, MD 20759  
 (410) 792-8086

### UTILITY CERTIFICATION

I HEREBY CERTIFY THAT THE EXISTING AND PROPOSED UNDERGROUND UTILITY INFORMATION SHOWN HEREON HAS BEEN CORRECTLY DUPLICATED FROM UTILITY COMPANY RECORDS, FURTHER THAT THIS PROJECT HAS BEEN CAREFULLY COORDINATED WITH THE INVOLVED UTILITY COMPANIES AND ALL UNDERGROUND UTILITY INFORMATION RELATIVE TO THIS PLAN HAS BEEN SOLICITED.

*Stephen Jerrick* 8/4/21  
 DATE  
 STEPHEN JERRICK, P.E.  
 MD REGISTRATION NO. 35792

KCI TECHNOLOGIES, INC.  
 11830 WEST MARKET PLACE, SUITE F  
 FULTON, MD 20759  
 (410) 792-8086

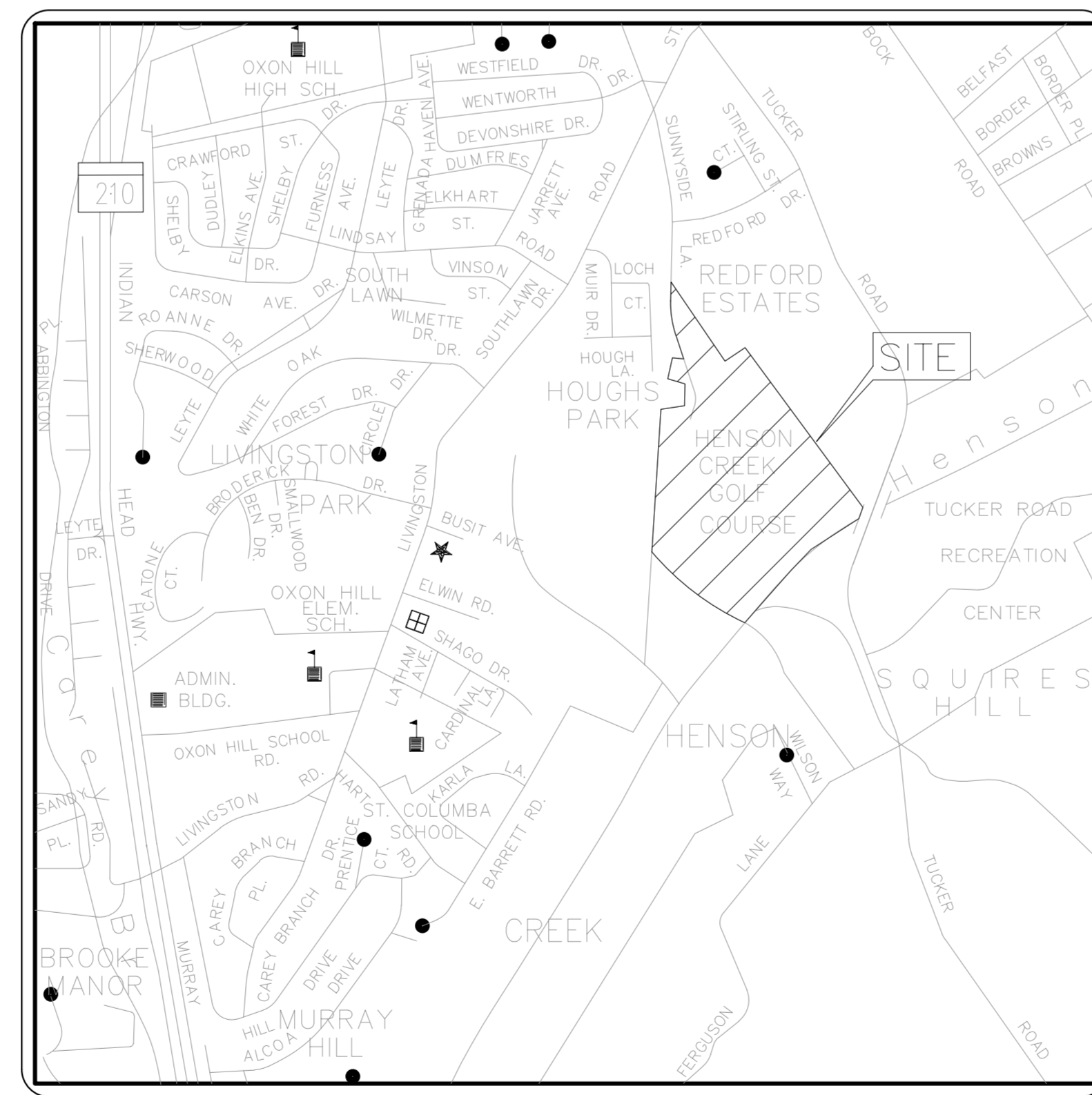

VICINITY MAP  
 SCALE: 1"=1000'

**STABILIZATION NOTE**  
 STABILIZATION PRACTICES ON ALL PROJECTS MUST BE IN COMPLIANCE WITH THE REQUIREMENTS OF COMAR 26.17.1.08 G REGULATIONS BY JANUARY 9, 2013, REGARDLESS OF WHEN AN EROSION AND SEDIMENT CONTROL PLAN WAS APPROVED. FOLLOWING INITIAL SOIL DISTURBANCE OR RE-DISTURBANCE, PERMANENT OR TEMPORARY STABILIZATION MUST BE COMPLETED WITHIN THREE (3) CALENDAR DAYS AS TO THE SURFACE OF ALL PERIMETER DIKES, SWALES, DITCHES, PERIMETER SLOPES, AND ALL SLOPES STEEPER THAN 3 HORIZONTAL TO 1 VERTICAL (3:1); AND SEVEN (7) CALENDAR DAYS AS TO ALL OTHER DISTURBED OR GRADED AREAS ON THE PROJECT SITE NOT UNDER ACTIVE GRADING.

**MISS UTILITY**  
 CALL "MISS UTILITY" AT 1-800-257-7777, 48 HOURS PRIOR TO THE START OF WORK. THE EXCAVATOR MUST NOTIFY ALL PUBLIC UTILITY COMPANIES WITH UNDERGROUND FACILITIES IN THE AREA OF PROPOSED EXCAVATION AND HAVE THOSE FACILITIES LOCATED BY THE UTILITY COMPANIES PRIOR TO COMMENCING EXCAVATION.

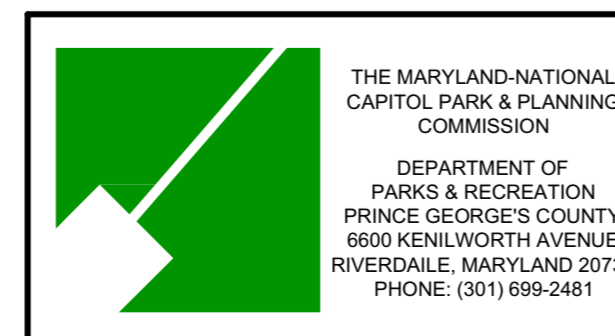

REVISIONS				DATE
NO.	DATE	DESCRIPTION	BY	
				8/3/2021
				SCALE AS SHOWN
				DESIGNED BY
				CHECKED BY

**HENSON CREEK BRIDGE REPAIR**  
 1641 TUCKER ROAD, Ft. Washington, MD 20744  
 SITE DEVELOPMENT FINE GRADING PLAN  
**TITLE SHEET**  
 ELECTION DISTRICT - 12  
 PRINCE GEORGE'S COUNTY, MARYLAND (20744)

DRAWING NO.  
**C-0.00**  
 SHEET 1 OF 4  
 KCI JOB NUMBER  
 271801182

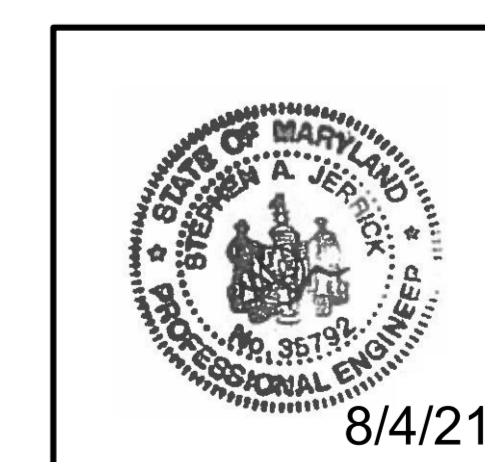

PROFESSIONAL CERTIFICATION. I HEREBY CERTIFY THAT THESE DOCUMENTS WERE PREPARED OR APPROVED BY ME AND THAT I AM DULY LICENSED PROFESSIONAL ENGINEER UNDER THE LAWS OF THE STATE OF MARYLAND, LICENSE NO. 35792 EXP. DATE: 8-16-2022

**Prince George's County Maryland**  
 Department of Permitting, Inspections & Enforcement  
**APPROVED PLAN SET**  
 SD-SWM ONLY

The Department of Permitting, Inspections and Enforcement has completed a review of this document for code compliance. As required by State Code, the design professional(s) responsible for the preparation and content of this document must provide a record copy of these documents with their original seal, signature and date.

Case Name: FORT WASHINGTON  
 Case Number (Plan Approval #): 17112-2021-9  
 Case Type: SDFG  
 Issuance Date: 8/4/2021  
 Address: 1641 TUCKER RD FORT WASHINGTON, MARYLAND  
 Lot(s) and Block(s): Lot and Block

**Conditions of Approval** **APPROVED**

The above approval is conditioned upon the following:

- This approval includes plan approval by DPIE for storm drain and stormwater management systems ONLY.
- Roadway systems (paving, sidewalk, curb/gutter, pavement marking, signage, signals and other roadway appurtenances), grading and permitting requires further review.
- This DOES NOT REPRESENT A PERMIT TO CONSTRUCT.

DEPARTMENT OF PERMITTING, INSPECTIONS AND ENFORCEMENT (DPIE)  
 PRINCE GEORGE'S COUNTY, MARYLAND  
**PEER REVIEW APPROVAL STAMP**

"I hereby certify that I have successfully completed participation in DPIE's Peer Review Program. I have reviewed these plans in detail and they are in conformance with the county's Code, General Specifications and Standards."

APPROVAL DATE: TECHNICALLY APPROVED ON 08/07/2021  
 PEER REVIEWER: SYLVESTER SETTLES, JR., P.E.  
 COMPANY NAME: RRU, LLC  
 PERMIT NUMBER: 17112-2021