

GENERAL NOTES

- ALL WORK SHALL BE IN ACCORDANCE WITH THE LATEST PRINCE GEORGE'S COUNTY STANDARDS AND SPECIFICATIONS MANUAL, THE LATEST PRINCE GEORGE'S COUNTY DETAIL MANUAL AND IN ACCORDANCE WITH CURRENT COUNTY ORDINANCES.
- CONTRACTOR IS RESPONSIBLE FOR CONTACTING "MISS UTILITY" AT 1-800-257-7777, 48 HOURS PRIOR TO ANY EXCAVATION WORK.
- THE DEVELOPER IS RESPONSIBLE TO HOLD A "PRECONSTRUCTION" MEETING TO INCLUDE THE CONTRACTOR, PRINCE GEORGE'S COUNTY INSPECTION PERSONNEL, PUBLIC UTILITIES, AND ANY LOCAL, STATE OR FEDERAL AGENCIES AS REQUIRED PRIOR TO THE START OF CONSTRUCTION.
- THE CONTRACTOR IS RESPONSIBLE FOR CONTACTING THE PRINCE GEORGE'S COUNTY DEPARTMENT OF PERMITTING, INSPECTION AND PERMITTING (DPIE) 5 DAYS PRIOR TO THE START OF ALL CONSTRUCTION IN ACCORDANCE TO ALL PERMITS ISSUED.
- MAXIMUM SLOPES SHALL BE NOT GREATER THAN THREE (3) FEET HORIZONTAL TO ONE (1) FOOT VERTICAL. OUTSIDE THE ROAD RIGHT-OF-WAY, SLOPES WITHIN THE ROAD RIGHT-OF-WAY SHALL BE NOT GREATER THAN TWO (2) FEET HORIZONTAL TO ONE (1) FOOT VERTICAL, OR UNLESS SPECIFIED ON THE PLANS.
- CERTIFIED COMPACTION TESTS ARE REQUIRED FOR ALL TRENCH/FILL WORK IN ACCORDANCE WITH THE LATEST EDITION OF THE SPECIFICATIONS MANUAL AND GRADING ORDINANCE. FINAL REPORTS AND CERTIFICATIONS SHALL BE PROVIDED PRIOR TO PRE-FINAL INSPECTIONS.
- CERTIFIED COMPACTION TESTS AND GEOTECHNICAL REPORTS SHALL BE SUBMITTED ON A REGULAR BASIS THROUGHOUT THE COURSE OF CONSTRUCTION AS REQUIRED BY THE SPECIFICATIONS MANUAL.
- AS-BUILT PLANS SHALL BE SUBMITTED PRIOR TO PRE-FINAL INSPECTIONS FOR ALL DISCIPLINES.
- WITH APPROVAL FROM THE PRINCE GEORGE'S COUNTY SEDIMENT CONTROL INSPECTOR, ALL EROSION AND SEDIMENT CONTROL STRUCTURES MUST BE REMOVED PRIOR TO THE RELEASE OF BONDS.
- THERE ARE NO KNOWN HISTORIC SITES LOCATED WITHIN THIS SITE.
- OBSTRUCTIONS SHOWN ON THIS DRAWING ARE FOR THE CONVENIENCE OF THE CONTRACTOR ONLY. THE CONTRACTOR MUST VERIFY ALL SUCH INFORMATION TO HIS OWN SATISFACTION. IN THE EVENT THAT INFORMATION IS IN CONFLICT WITH INFORMATION OUTLINED, THE CONTRACTOR SHALL IMMEDIATELY NOTIFY THE ARCHITECT PRIOR TO STARTING ANY WORK.
- ADJUST TOP OF CURB GRADES TO SMOOTH TRANSITION.
- STRIP AND RESURFACE EXISTING PAVING AS NEEDED TO PROVIDE SMOOTH TRANSITION TO EXISTING SURFACE.
- IT SHALL BE DISTINCTLY UNDERSTOOD THAT FAILURE TO MENTION SPECIFICALLY ANY WORK WHICH WOULD NORMALLY BE REQUIRED TO COMPLETE THIS PROJECT SHALL NOT RELIEVE THE CONTRACTOR OF HIS RESPONSIBILITY TO COMPLETE SUCH WORK.
- IT SHALL BE THE RESPONSIBILITY OF THE CONTRACTOR TO NOTIFY THE ENGINEER OF ANY DEVIATION FROM THIS PLAN PRIOR TO ANY CHANGE BEING MADE. ANY DEVIATION FROM THIS PLAN WITHOUT WRITTEN AUTHORIZATION FROM THE ENGINEER WILL BE THE RESPONSIBILITY OF THE CONTRACTOR.
- SHOULD THE CONTRACTOR DISCOVER DISCREPANCIES BETWEEN THE PLANS AND FIELD CONDITIONS, THE ENGINEER IS TO BE NOTIFIED IMMEDIATELY TO RESOLVE THE SITUATION. SHOULD THE CONTRACTOR MAKE FIELD CORRECTIONS OR ADJUSTMENTS WITHOUT NOTIFYING THE ENGINEER, THEN THE CONTRACTOR ASSUMES ALL RESPONSIBILITY FOR THOSE CHANGES.
- THE CONTRACTOR SHALL NOTE THAT IN CASE OF ANY DISCREPANCY BETWEEN THE SCALED AND FIGURED DIMENSIONS SHOWN ON THESE PLANS THE FIGURED DIMENSIONS SHALL GOVERN.
- PRIOR TO BEGINNING CONSTRUCTION, THE CONTRACTOR SHALL VERIFY ALL TIE-IN ELEVATIONS.
- FILL IN STRUCTURAL AND PAVEMENT AREAS SHALL BE PLACED IN HORIZONTAL, EIGHT-INCH MAXIMUM LOOSE LIFTS AND COMPACTED TO AT LEAST 98 PERCENT OF THE MODIFIED PROCTOR MAXIMUM DRY DENSITY PER ASTM D-1557. IN AREAS TO SUPPORT FLOOR SLABS AND PAVEMENTS THE UPPERMOST ONE FOOT (AFTER COMPACTION) SHALL BE COMPACTED TO 98 PERCENT OF THE MAXIMUM DRY DENSITY. THE MOISTURE CONTENT OF THE FILL SHALL BE PROPERLY CONTROLLED DURING PLACEMENT. IN BUILDING AREAS FILL SHALL EXTEND A MINIMUM OF 10 FEET BEYOND THE BUILDING LIMITS AND FILL SLOPES NO STEEPER THAN 2:1 SHALL BE USED. SEE THE PROJECT SPECIFICATIONS FOR ADDITIONAL INFORMATION.
- ALL CONSTRUCTION SHALL BE COMPLETED IN ACCORDANCE WITH THE LATEST PRINCE GEORGE'S COUNTY STANDARD DETAILS AND SPECIFICATIONS.
- CONTRACTOR WILL ADJUST ALL FRAMES, GRATES AND COVERS OF ALL EXISTING UTILITIES WITHIN THE LIMITS OF THE CONTRACT TO THE PROPOSED GRADES, AS REQUIRED.
- THE CONTRACTOR WILL MAINTAIN POSITIVE DRAINAGE TO SWALES AND/OR STORM DRAIN SYSTEMS AT ALL TIMES.
- ALL EXCESS SOILS ARE TO BE DISPOSED OF ON SITE, DURING FUTURE PHASES OF THE PROPERTY, AND OR STOCKPILED IN THE LOCATION OF THE BUILDING BEING DEMOLISHED ON THE PROPERTY.

"THE MARYLAND - NATIONAL CAPITOL PARK AND PLANNING COMMISSION"
 "DEPARTMENT OF PARKS AND RECREATION"
 "PRINCE GEORGE'S COUNTY"

HENSON CREEK BRIDGE REPAIR

1641 TUCKER ROAD
 FORT WASHINGTON, MARYLAND 20744
 PRINCE GEORGE'S COUNTY

OWNER/APPLICANT:
 M-NGPC
 7833 WALKER DRIVE, 3RD FLOOR
 GREENBELT, MD 20770
 PHONE: (301) 454-1469
 CONTACT: COLLEEN REGOTTI

ENGINEER:
 KCI TECHNOLOGIES, INC.
 11830 WEST MARKET PLACE, SUITE F
 FULTON, MARYLAND 20759
 PHONE: (410) 792-8086
 CONTACT: STEPHEN JERRICK, P.E.

SITE DATA:
 ADDRESS: 1641 TUCKER ROAD
 FORT WASHINGTON, MARYLAND 20744
 TAX IDENTIFICATION NO.: 1286442
 TAX MAP/GRID: 0018/00C1
 PARCEL: 0000
 LIBER/FOLIO: 02512/421
 WSSC: 200FT. SHEET: 210SE02
 ELECTION DISTRICT: 12
 WATER DESIGNATION: W-5
 SEWER DESIGNATION: S-5
 SITE AREA: 55.21 ACRES
 ZONING: R-O-S
 LIMIT OF DISTURBANCE: 0.81 ACRES
 EX. IMPERVIOUS: 0.06 ACRES
 PROP. IMPERVIOUS: 0.03 ACRES

| OVERALL SHEET # | SCD SHEET # | DPIE SHEET # | SHEET NUMBER | SHEET DESCRIPTION |
|-----------------|-------------|--------------|--------------|---|
| 1 | | | C-0.00 | TITLE SHEET |
| 2 | | 1 | C-0.00 | TITLE SHEET (DPIE) |
| 3 | | | C-0.01 | OVERALL EXISTING CONDITIONS PLAN |
| 4 | | 2 | C-1.00 | OVERALL SITE GRADING PLAN |
| 5 | | 3 | C-1.01 | SITE DETAILS |
| 6 | | 4 | C-1.02 | BORING LOG PLAN |
| 7 | | | C-2.00 | SITE DEVELOPMENT CONCEPT PLAN |
| 8 | 1 | | C-3.00 | OVERALL EROSION & SEDIMENT CONTROL PLAN PHASE 1 |
| 9 | 2 | | C-3.01 | OVERALL EROSION & SEDIMENT CONTROL PLAN PHASE 2 |
| 10 | 3 | | C-3.02 | OVERALL EROSION & SEDIMENT CONTROL PLAN PHASE 3 |
| 11 | 4 | | C-3.03 | OVERALL EROSION & SEDIMENT CONTROL PLAN PHASE 4 |
| 12 | 5 | | C-3.04 | OVERALL EROSION & SEDIMENT CONTROL PLAN PHASE 5 |
| 13 | 6 | | C-3.05 | STREAM CHANNEL PROFILE |
| 14 | 7 | | C-3.06 | EROSION & SEDIMENT CONTROL NOTES |
| 15 | 8 | | C-3.07 | EROSION & SEDIMENT CONTROL NOTES |
| 16 | 9 | | C-3.08 | EROSION & SEDIMENT CONTROL NOTES |
| 17 | 10 | | C-3.09 | EROSION & SEDIMENT CONTROL NOTES |
| 18 | 11 | | C-3.10 | EROSION & SEDIMENT CONTROL NOTES |
| 19 | 12 | | C-3.11 | OVERALL EXISTING CONDITIONS PLAN |
| 20 | 13 | | C-3.12 | EROSION & SEDIMENT CONTROL SEQUENCE OF CONSTRUCTION |
| 21 | | | C-4.00 | CONTRACTOR ROUTING PLAN |
| 22 | | | SC-01 | STREAM CHANNEL PLAN VIEW |
| 23 | | | SC-02 | STREAM CHANNEL PROFILE |
| 24 | | | SC-03 | STREAM CHANNEL DETAILS |
| 25 | | | SC-04 | STREAM CHANNEL CROSS SECTIONS |
| 26 | | | SC-05 | STREAM CHANNEL CROSS SECTIONS |
| 27 | | | SC-06 | STREAM CHANNEL CROSS SECTIONS |
| 28 | | | S-1.00 | STRUCTURAL NOTES AND PLAN VIEW |
| 29 | | | S-1.01 | ABUTMENT SECTIONS AND DETAILS |
| 30 | | | S-2.00 | CONTECH BRIDGE ELEVATION AND DETAILS |

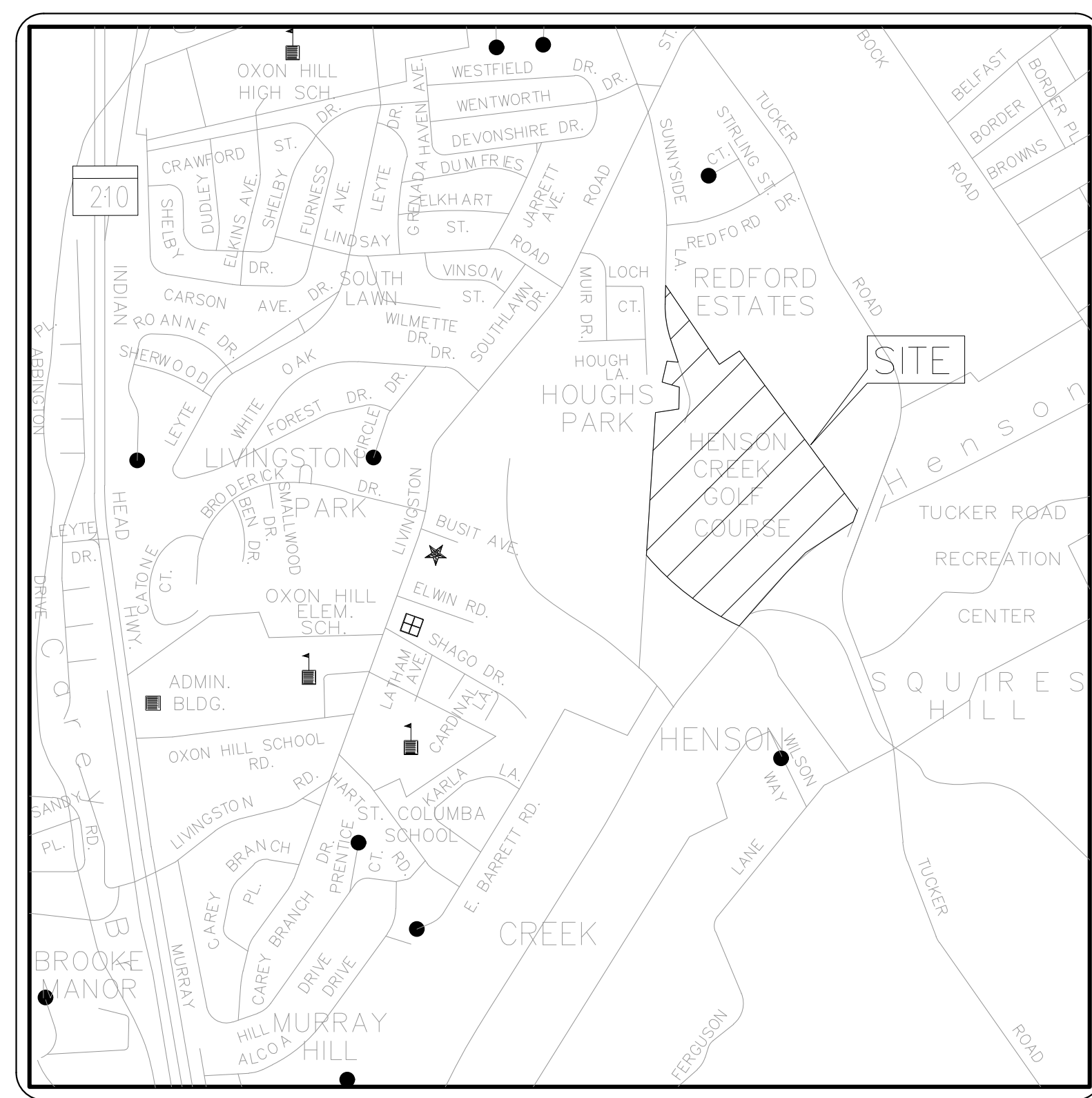

VICINITY MAP
 SCALE: 1"=1000'

GRADING & DRAINAGE CERTIFICATION

I HEREBY CERTIFY THAT THIS PLAN CONFORMS TO THE REQUIREMENTS OF SUBTITLE 32, DIVISION 2 OF THE CODE OF PRINCE GEORGE'S COUNTY WATER RESOURCES PROTECTION AND GRADING CODES AND THAT I OR MY STAFF HAVE INSPECTED THIS SITE AND THAT DRAINAGE FLOWS FROM UPHILL PROPERTIES ONTO THIS SITE, AND FROM THIS SITE ONTO DOWNHILL PROPERTIES, HAVE BEEN ADDRESSED IN SUBSTANTIAL ACCORDANCE WITH APPLICABLE CODES.

STEPHEN JERRICK, P.E. DATE
 MD REGISTRATION NO. 35792

KCI TECHNOLOGIES, INC.
 11830 WEST MARKET PLACE, SUITE F
 FULTON, MD 20759
 (410) 792-8086

UTILITY CERTIFICATION

I HEREBY CERTIFY THAT THE EXISTING AND PROPOSED UNDERGROUND UTILITY INFORMATION SHOWN HEREON HAS BEEN CORRECTLY DUPLICATED FROM UTILITY COMPANY RECORDS, FURTHER THAT THIS PROJECT HAS BEEN CAREFULLY COORDINATED WITH THE INVOLVED UTILITY COMPANIES AND ALL UNDERGROUND UTILITY INFORMATION RELATIVE TO THIS PLAN HAS BEEN SOLICITED.

STEPHEN JERRICK, P.E. DATE
 MD REGISTRATION NO. 35792

KCI TECHNOLOGIES, INC.
 11830 WEST MARKET PLACE, SUITE F
 FULTON, MD 20759
 (410) 792-8086

STABILIZATION NOTE

STABILIZATION PRACTICES ON ALL PROJECTS MUST BE IN COMPLIANCE WITH THE REQUIREMENTS OF COMAR 26.17.1.03 G REGULATIONS BY JANUARY 9, 2013. REGARDLESS OF WHEN AN EROSION AND SEDIMENT CONTROL PLAN WAS APPROVED, FOLLOWING INITIAL SOIL DISTURBANCE OR RE-DISTURBANCE, PERMANENT OR TEMPORARY STABILIZATION MUST BE COMPLETED WITHIN THREE (3) CALENDAR DAYS AS TO THE SURFACE OF ALL PERIMETER DIKES, SWALES, DITCHES, PERIMETER SLOPES, AND ALL SLOPES STEEPER THAN 3 HORIZONTAL TO 1 VERTICAL (3:1); AND SEVEN (7) CALENDAR DAYS AS TO ALL OTHER DISTURBED OR GRADED AREAS ON THE PROJECT SITE NOT UNDER ACTIVE GRADING.

MISS UTILITY

CALL "MISS UTILITY" AT 1-800-257-7777, 48 HOURS PRIOR TO THE START OF WORK. THE EXCAVATOR MUST NOTIFY ALL PUBLIC UTILITY COMPANIES WITH UNDERGROUND FACILITIES IN THE AREA OF PROPOSED EXCAVATION AND HAVE THOSE FACILITIES LOCATED BY THE UTILITY COMPANIES PRIOR TO COMMENCING EXCAVATION.

PROFESSIONAL CERTIFICATION. I HEREBY CERTIFY THAT THESE DOCUMENTS WERE PREPARED OR APPROVED BY ME AND THAT I AM DULY LICENSED PROFESSIONAL ENGINEER UNDER THE LAWS OF THE STATE OF MARYLAND. LICENSE NO. 35792 EXP. DATE: 8-16-2022

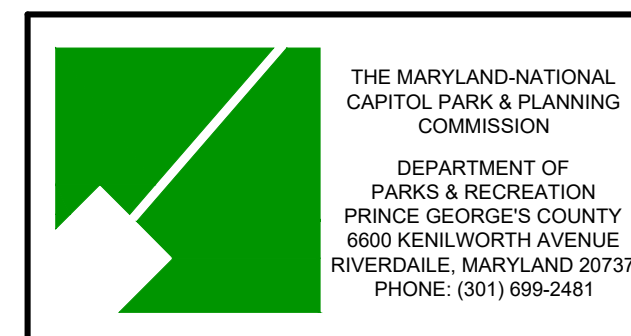

ENGINEERS
 PLANNERS
 SCIENTISTS
 CONSTRUCTION MANAGERS

KCI TECHNOLOGIES
 11830 WEST MARKET PLACE, SUITE F
 FULTON, MD 20759
 TELEPHONE: (410) 792-8086
 FAX: (410) 792-7419

| REVISIONS | | | |
|-----------|------|-------------|----|
| NO. | DATE | DESCRIPTION | BY |
| | | | |
| | | | |
| | | | |
| | | | |
| | | | |
| | | | |
| | | | |
| | | | |
| | | | |
| | | | |

DATE: 8/10/2021
 SCALE: AS SHOWN
 DESIGNED BY: AJ
 CHECKED BY: SJ

HENSON CREEK BRIDGE REPAIR
 1641 Tucker Road, Ft. Washington, MD 20744
 SITE DEVELOPMENT FINE GRADING PLAN

TITLE SHEET

ELECTION DISTRICT - 12
 PRINCE GEORGE'S COUNTY, MARYLAND (20744)

DRAWING NO.
C-0.00
 SHEET 1 OF 4
 KCI JOB NUMBER
 271801182